

www.childrenscentralcal.org

9300 Valley Children's Place

Madera, CA 93636-8762

Neurology Practice Phone: **(559) 353-6215**

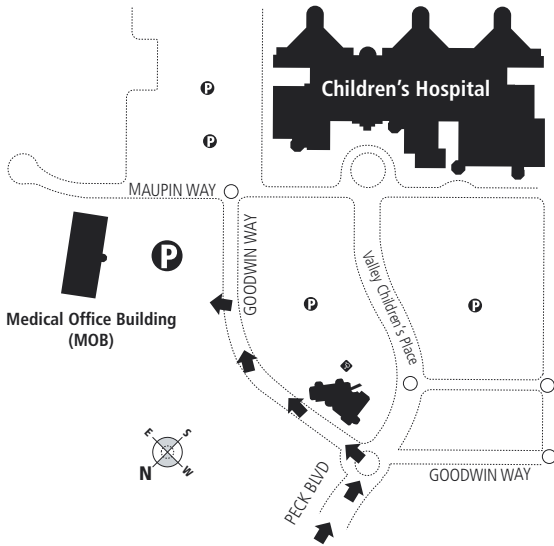

This is the Medical Office Building (MOB).

Go to the Medical Office Building (MOB) located north-east of the Hospital. It is on your left as you drive in.

2 Your appointment is on the **Second Floor** ↑

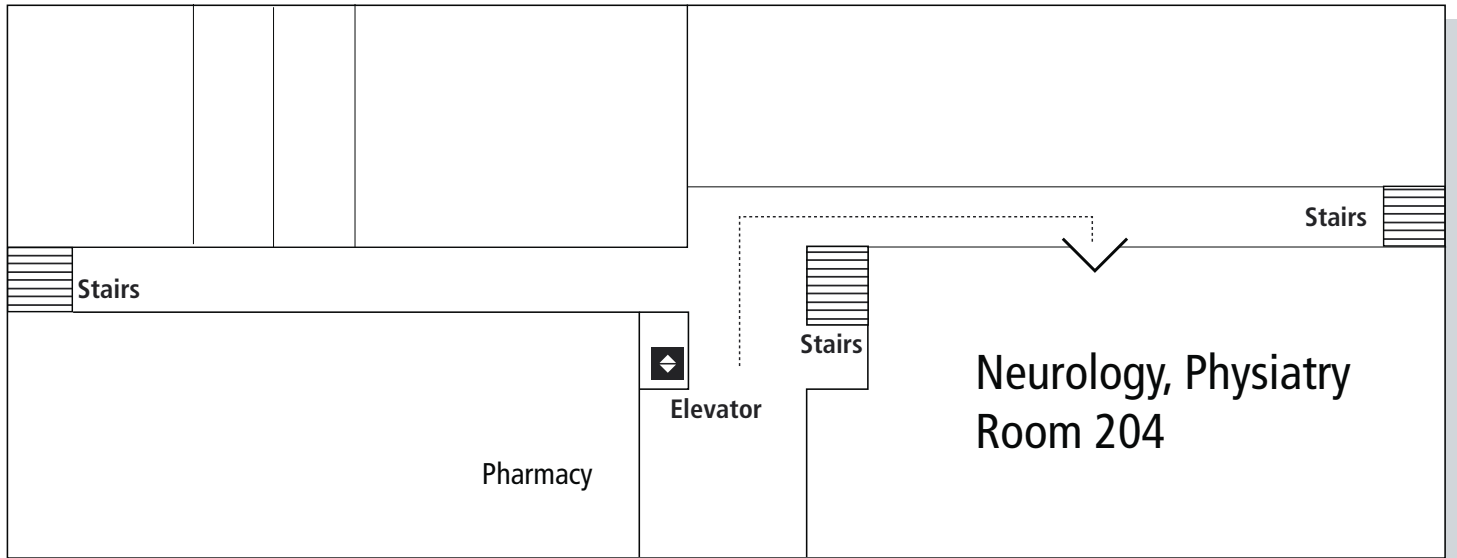

Enter the Medical Office Building (MOB) through the main entrance. Take the elevator or stairs to the second floor. Take the hallway on your right. The Neurology & Physiatry Practices are on the right side of the hall.