

www.childrenscentralcal.org

9300 Valley Children's Place
Madera, CA 93636-8762

Diabetes: **(559) 353-6600** Endocrinology: **(559) 353-8700**

High Risk Infant Assessment & Follow-Up: **(559) 353-6733**

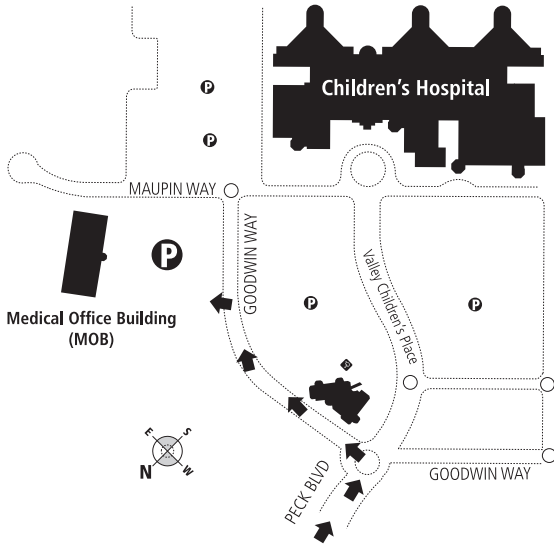

This is the Medical Office Building (MOB).

Go to the Medical Office Building (MOB) located north-east of the Hospital. It is on your left as you drive in.

1 Your appointment is on the First Floor

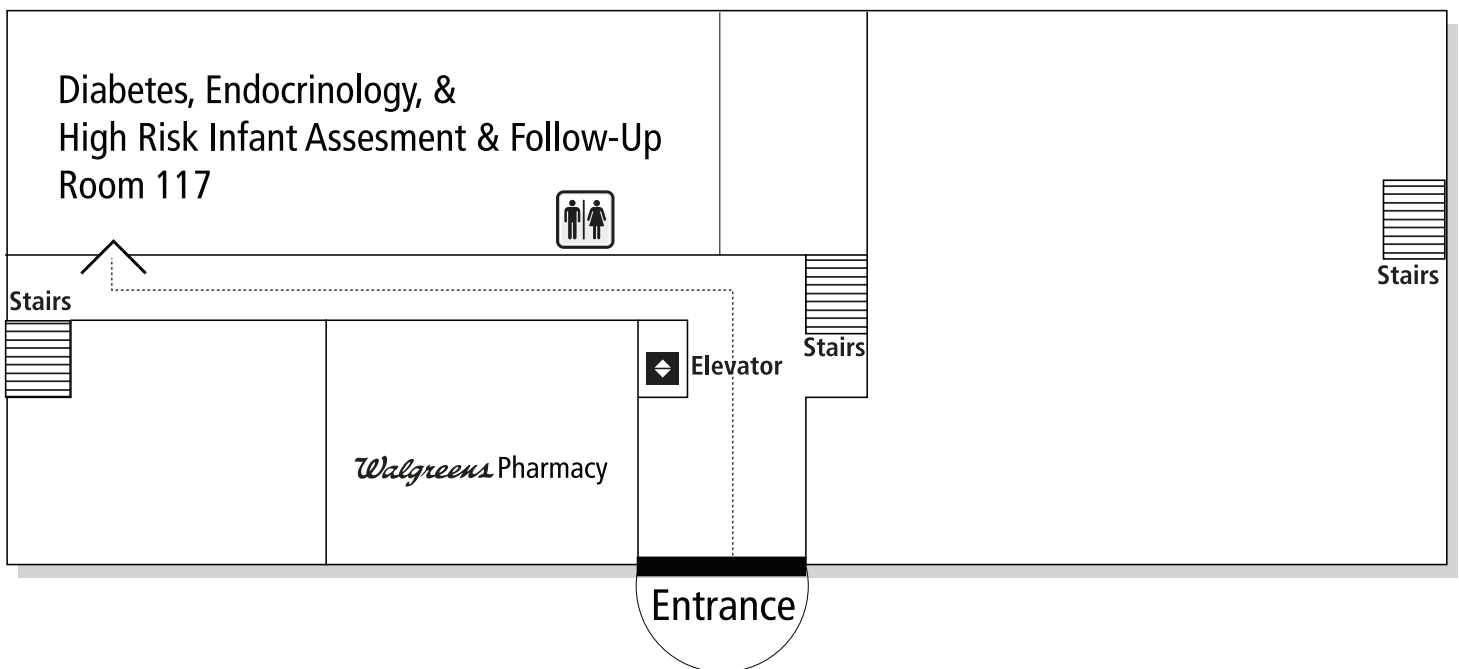

Enter the Medical Office Building (MOB) through the main entrance. Go past the elevators and take the hallway to the left. The Diabetes, Endocrinology and High Risk Infant Follow-Up Practices are at the end of the hall on the right.